

Architecture has been called the art of making spaces.
Space and the sense of enclosure are important concepts in
designing.

SPACE INTERIOR is a team of Civil Engineers, Architect & Interior Designers, rendering services for commercial interiors, office interiors, residential interiors, consultant projects and restoration and maintenance works.



Space Interior is one of the leading Interior Designers & Decorators. We have successfully executed several projects in the last 20 years of our establishment. It is needless to say that we have been able to satisfy all our clients because of our professional teamwork such as Architect, Skilled workers, Administrative staff and Supervisors.

Our experience and the professional setup makes us capable of undertaking turnkey projects of carpentry, civil, painting, plumbing, P.O.P, etc., works. It is needless to say that we have since 20 years we have pioneered our self to serve in the retail industry.

Who We Are ?

- ARCHITECTURAL & INTERIOR DESIGNING
- ENGINEERING CONSULTANCY
- PROJECT MANAGEMENT
- STRUCTURAL ENGINEERING
- AIR-CONDITIONING,
- HEATING & VENTILATION SYSTEM
- COMPUTER NETWORKING (DATA & VOICE)
- SMOKE DETECTION / FIRE FIGHTING SYSTEM
- ACCESS CONTROL SYSTEM
- VIDEO IMAGING SYSTEM
- PUBLIC ADDRESS / MUSIC SYSTEM
- DG SET / UPS
- BUILDING MANAGEMENT SYSTEM

- CIVIL WORK
- P.O.P. & PAINTING WORK
- ALL TYPES OF FALSE CEILING
- PLUMBING & SANITATION
- GLAZING & CLADDING
- METAL FABRICATION WORKS
- RAISED FLOORING
- MODULAR FURNITURE
- LOOSE FURNITURE
- CUSTOMISED FURNITURE
- STORAGEES & CABINETS
- CARPETS
- CHAIRS

Mr. Niraj Harish Shyamani:- Proprietor of the Company
Degree In Civil Engineering (B.E.CIVIL), passed from Pune University
Diploma in Interior Designing and Decoration.

Mr Harish N.Shyamani –. Associate/Partner in the Company.
Registered with INDIAN COUNCIL OF ARCHITECTURE- DELHI- to practice as an Architect all over India,
Registered member of INDIAN INSTITUTE OF ARCHITECTS (AIIA),
Member on the panel of Practising Engineers Architects & Town planners Association (PEATA),
Also Registered with /on the panel of Mumbai Municipal Corporation (MMC)-as an Architect to undertake Govt.
related projects in city limits, suburbs and extended suburbs.
Licensed Supervisor of 'A' Category to execute/supervise the actual construction activity for private as well as
Govt. Projects.

Mr Anil Majithia: Associate in the Company since 20 years
Registered Civil Engineer with the Indian Institute For Engineers (IIE)
Also Member of Institute Of Valuers(MIV)
Bank Panel Valuer for some of the reputed nationalized and Co-operative Banks like Union Bank of India,
Dena Bank, Saurashtra Bank, Bombay Mercantile Co-op. Bank etc

Team of Experts

Mr. Viren Harish Shyamani: Associate/Partner in the Company since 4 years
Licentiate Diploma In Civil & Environmental Engineering (L.C.E.E) &
Degree In Civil Engineering (B.E.CIVIL), passed from V.J.T.I.(affiliated with the Mumbai University).
Worked as Site Engineer for 2 years, then on achieving the Supervisor License from Mumbai Municipal Corporation,
joined the professional service with our company.

Mrs Payal Shyamani:- Associate in the Company since 8 years.
A full fledged diploma holder in Interior Designing and Decoration

Mr. Prakash Mewada: Associate in the Company since 8 years.
Interior Designer and CAD (Computer Aided Designing) operator.

Miss. Tejal Pawar: Associate in the Company since 7 yrs.
A full fledged diploma holder in Interior designing and decoration, who handles the (CAD) section of our company.

Ms. Vinita Das: Associate in the Company since 7 yrs.
A full fledged diploma holder in Interior designing and decoration, who handles the (CAD) section of our company.

Team of Experts

Ms.Pragati Pimpalkar:Associate in the Company since 4 yrs.

A full fledged diploma holder in Interior designing and decoration,who handles the(CAD)section of our company.

Mr.Zubair Shaikh:Associate in the Company since 7 yrs.

A full fledged diploma holder in Interior designing and decoration,who handles the(CAD)section & Sites of our company.

Ms.Sonal Nawale :Associate in the Company since 2 yrs.

A full fledged diploma holder in Interior designing and decoration,who handles the(CAD)section of our company.

Mr.Vishal Saini :Associate in the Company since 2 yrs.

A full fledged diploma holder in Interior designing and decoration,who handles the(CAD)section & Sites of our company.

Team of Experts

Mr. Niraj Harish Shyamani: He undertakes the interior designing /decoration of residential and commercial premises since 12 years. He also renders his services as a Consultant to various exterior as well interior projects.

Mr. Harish N. Shyamani: Working as a private Architect/ professional service since 36 years and on the Govt. Panel since 20 years. He has successfully completed the restoration of a number of dilapidated buildings under the jurisdiction of Mumbai Municipal Corporation in South Mumbai Also involved in elevational treatment of heritage buildings and maintenance of such age-old structures.

Mr Anil Majithia: An experienced civil Engineer &Architect and Bank panel Valuer since 32 years. He has a proved elemental in various maintenance/restoration undertaken by the company. Also being a panel valuer is efficient in computing the potentiality of properties and their market value for sale/mortgage.

Mr.Viren Harish Shyamani: The role in the company is to prepare As-Built Plans of the buildings under restoration / redevelopment, the Detailed Estimation for various Govt. Jobs, site supervision on regular basis, preparing site report and forwarding the same to respective Govt., offices, preparation of documentation/ compliances for acquiring the necessary building approval from the Govt. offices, checking contractors Running account Bills etc.

Mrs. Payal Shyamani, Mr. Prakash Mewada, Miss. Tejal Pawar , Ms. Vinita Das, Ms. Pragati Pimpalkar, Mr. Zubair Shaik ,& Ms. Sonal Nawale.:-Are the key players in preparation of Interior Layouts using CAD and 3D Max. Also the complete documentation /databases of works in hand , their current status, expenditure involved etc is kept on record by them

CONCEPT & DESIGN

- ❖ BASIC CONCEPT
- ❖ ALTERNATIVE LAYOUT PLANS
- ❖ ELEVATIONS
- ❖ SKETCHES
- ❖ BUDGETARY ESTIMATE/TENDER
- ❖ LIST OF MATERIALS
- ❖ DETAILED DESIGN & FINAL ESTIMATE
- ❖ LIST OF APPROVED MANUFACTURERS
- ❖ DETAILED DRAWINGS.

POINTS CONSIDERED

- ❖ ACOUSTICS
- ❖ ERGONOMICS
- ❖ WORKSTATION DESIGN & LAYOUT
- ❖ CAFETERIA
- ❖ RECREATION AREA
- ❖ ELECTRICAL LAYOUT
- ❖ STPI BENEFITS
- ❖ AESTHETICS
 - COLORS
 - LIGHTING
 - FLOORING
 - CEILING

Design Approach

- ❖ APPROVAL FROM CLIENT
- ❖ TENDERING & DETAIL DRAWING
- ❖ NEGOTIATIONS WITH VENDERS / CONTRACTOR
- ❖ AWARDING OF CONTRACTORS
- ❖ SITE OFFICE
- ❖ PROJECT KICK OFF MEETING
- ❖ MOBILIZATION OF MATERIALS
- ❖ MEETING OF RELATED SERVICE CONTRACTORS
- ❖ MOCK-UP OF FURNITURE ON SITE
- ❖ WEEKLY SITE MEETING
- ❖ WEEKLY PROGRESS REPORTS
- ❖ PROJECT REVIEW MEETING WITH CLIENT
- ❖ COMMISSIONING OF VARIOUS SYSTEMS
- ❖ TESTING & CERTIFICATION
- ❖ SNAG LIST & DEFECTS RECTIFICATION
- ❖ AS BUILT DRAWING & FINAL BILL CERTIFICATION
- ❖ PROJECT COMPLETION MANUAL
- ❖ PROJECT HANDOVER

Execution Process

- ❖ PROPER DETAIL DRAWINGS
- ❖ SELECTION OF REPUTED CONTRACTORS / MATERIALS / VENDORS
- ❖ CHECKING OF MATERIAL AT ENTRY POINT TO ENSURE QUALITY
- ❖ MOCKUPS OF MAJOR ITEMS : MODULAR, CHAIRS, CARPET, LIGHT FIXTURES
- ❖ ARRAINGING WEEKLY MEETING WITH CLIENT/CONTRACTOR
- ❖ SETUP OF SITE OFFICE FOR IMMEDIATE SERVICE TO THE CLIENT
- ❖ TESTING & CERTIFICATION IS TO BE DONE BEFORE COMMISSIONING

Quality Control

- ❖ UNDERSTANDING PROPERLY THE REQUIREMENTS OF CLIENT
- ❖ EVALUATING EXACT QUANTITIES
- ❖ BUFFER FOR BUDGET APPROVAL BY CONTINGENCIES
- ❖ AVOIDING MAJOR EXTRA ITEMS
- ❖ APPROVAL FOR EXTRA ITEMS BY PROPER RATE ANALYSIS
- ❖ UPDATING CLIENT WITH PROJECTED FINAL COST

- ENERGY CONSERVATION
- APPLICATION
- CABINETS & WORKSTATIONS
- CARPETING
- FLOORING

- FURNITURE
- LIGHTING
- WALLS
- AIR-CONDITIONING
- ERGONOMICALLY DESIGNED CHAIRS PROPOSAL

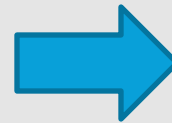
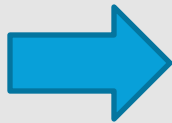
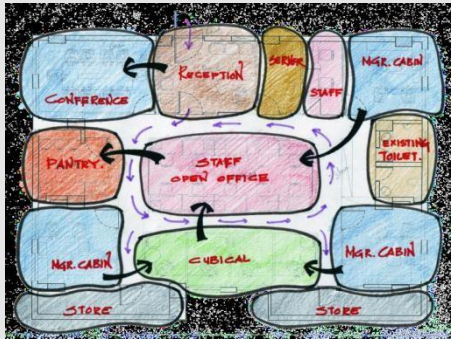

Concept

Plan

3d Sketch

- Kapoorchand & Co.
- M/s. FerroDye pvt. Ltd
- Indian Hotels Pvt. Ltd. (Old Taj Group)
- Parsi Panchayat, Mumbai
- ❖ Agarwal House – Little Lodge
- Mumbai MHADA Bldg. Repairs & Reconstruction Board
- YMCA International House
- Cox & Kings (Pan India)
- Alkem Limited (Pan India)
- Hindustan Uniliver Ltd
- ITC Group of Companies
- Chalet Hotels
- Rotary Club of Mumbai
- World Courier Pvt Ltd
- Siddhivinayak Enterprises
- Lifecell Internatinal Pvt Ltd
- Vimal Fire Shoot Pvt. Ltd, Vikroli
- Tricom India Ltd
- IPCA Labs
- Delta Corporation Ltd
- Hitachi India Pvt Ltd
- Navis Capital, B.K.C
- Newgen Software Technologies Ltd
- Polaris Software Pvt Ltd
- Speedfam Pvt Ltd
- Crompton Greaves Ltd
- Annett Technologies
- Inventurs Knowledge Solutions Pvt Ltd.
- Cipla
- Wellspring Healthcare Pvt Ltd

